

Preset Dual Dimmer
Incandescent/Mains Voltage Halogen
LLDI-252, LNDI-252
Rated at: 220–240 V~ 50 Hz 40–250 W



Slide To Off Dual Dimmer
Incandescent/Mains Voltage Halogen
LSDI-251
Rated at: 220–240 V~ 50 Hz 40–250 W



Important Notes

Please read before installing.

- WARNING:** Do not use LLDI-252, LNDI-252 or LSDI-251 with magnetic (core and coil) low-voltage transformers or electronic (solid-state) low-voltage transformers.
- CAUTION:** To avoid overheating and possible damage to other equipment, do not use to control receptacles, fluorescent lighting fixtures, motor-operated or transformer-supplied appliances.
- Turn power OFF at MCB (circuit breaker) or fuse box before performing any routine maintenance or servicing of lighting circuit.
- For new installations, install a test switch before installing the Dual Dimmer to verify no short in the wiring.
- Protect Dual Dimmer from dust and dirt when painting or during construction.
- Only one Dual Dimmer can be used in a 2-way circuit.
- Dual Dimmer requires a minimum total lamp wattage of 40 W on each dimmer side. Do not exceed the maximum rating of 250 W per dimmer side.
- This Dual Dimmer complies with IEC and EN 60669-2-1.
- Minimum backbox depth is 35 mm.**
- Install in accordance with all national and local electrical codes.
- Operate between 0 °C and 40 °C. For indoor use only.
- Dual Dimmer may not work with dioded lamps.
- It is normal for the Dual Dimmer to feel warm to the touch during operation.
- Clean with a soft damp cloth only. DO NOT** use any chemical cleaners.
- Recommended torque for terminal block screws is 0.5 N•m.

Technical Assistance

If you have questions concerning the installation or operation of this product, call **Lutron's Headquarters**. Please provide exact model number when calling.

Lutron EA LTD Tel: +44 (0) 207 702 0657 Fax: +44 (0) 207 480 6899 www.lutron.com/europe	FREEPHONE: U.K.: 0800-282107 Spain: 900-974452 Northern China: 10-800-712-1536 Southern China: 10-800-120-1536 Hong Kong: 800-901-849 Singapore: 800-120-4491 Taiwan: 00-801-137-737 Thailand: 001-800-120-665853
Lutron GL LTD Tel: +852-2104-7733 Fax: +852-2104-7633 www.lutron.com/asia	

Limited Warranty

Lutron EA Ltd. ("Lutron EA") warrants each unit to be free from defects in material and workmanship and to perform under normal use and service. To the extent permitted by law, Lutron EA and Lutron Electronics Co. Inc. ("Lutron") make no warranties or representations as to the units except as set forth herein. This warranty shall run for a period of two years from the date of purchase and Lutron's obligations under this warranty are limited to remedying any defect, replacing any defective part or replacement (at Lutron EA's sole option) and shall be effective only if the defective unit is shipped to Lutron EA postage prepaid within 24 months after purchase of the unit. Repair or replacement of the unit does not affect the expiry date of the warranty. This warranty does not cover damage or deficiencies due to abuse, misuse, inadequate wiring or insulation or use or installation other than in accordance with instructions accompanying the unit. To the extent permitted by law, neither Lutron EA nor Lutron shall be liable for any other loss or damage including consequential or special loss or damages, loss of profits, loss of income, or loss of contracts arising out of or relating to the supply of the unit or the use of the unit and the purchaser assumes and will hold harmless Lutron EA and Lutron in respect of all such loss or damage. Nothing in this warranty shall have the effect of limiting or excluding Lutron EA's or Lutron's liability for fraud or for death or personal injury resulting from its own negligence, or any other liability, if and to the extent that the same may not be limited or excluded as a matter of law. **This warranty does not affect the statutory rights of consumer purchasers of this product.** Although every attempt is made to ensure that catalogue information is accurate and up-to-date, please check with Lutron EA before specifying or purchasing this equipment to confirm availability, exact specifications, and suitability for your application. EC Registered Design Nos 000409610 and 000409628; and corresponding patents and design registrations of other countries. Patents pending. Lutron is a registered trademark in the United Kingdom and the Community Trademark System and Lyneo is a trademark of Lutron Electronics Co., Inc. © 2006 Lutron Electronics Co., Inc.

Installation

1 **WARNING:** Turn power OFF at MCB (circuit breaker) or fuse box.

2 **Remove switch mounting screws. Remove switches from wall.**

Note: DO NOT disconnect wires from the switches.

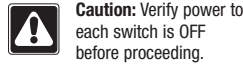

Caution: Verify power to each switch is OFF before proceeding.

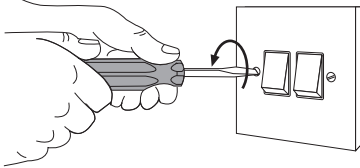

3 **Tag the wire(s).**

Note: Perform one of the following procedures on each switch.

Single-Location control

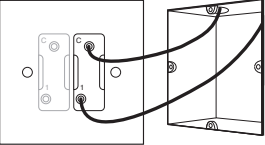

One switch controlling a light fixture.

No tagging is needed. This switch will be a 1-way. The switch will have insulated wires connected to two terminals.

See Step 6a when wiring.

Two-Location control

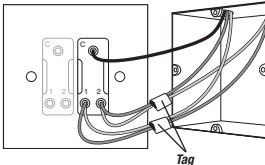

Two switches controlling a light fixture.

TAPE the two wires connected to the terminal labelled 1 together for identification during wiring. **TAPE** the two wires connected to the terminal labelled 2 together. Both switches will be 2-way. One switch will have five insulated wires connected to three terminals and the other switch will have three insulated wires connected to three terminals. To replace a switch connected to three wires, see instructions on reverse.

See Step 6b when wiring.

Note: Terminal placement may be different on your existing switch.

Important Note:

Your wall switch may have two wires attached to the same terminal. Tape these two wires together before disconnecting. Connect these two wires to the same terminal in Step 6.

4 **Disconnect switch wires.**

5 **Prepare Dual Dimmer for installation.**

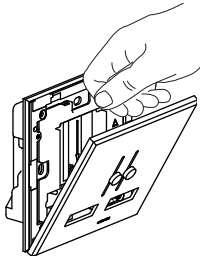

Snap off Front Plate

6 **Wiring the control.**

Important Wiring Information



WARNING: Permanent damage can be caused by overtightening the terminal screws. Recommended torque for terminal block screws is 0.5 N•m.

Trim or strip backbox wires to 8 mm. Insert wires fully into the terminals and tighten screws.

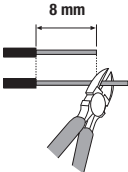

Notes:

- Perform one of the following procedures on each side of the Dual Dimmer.

6a - Single-Location Wiring

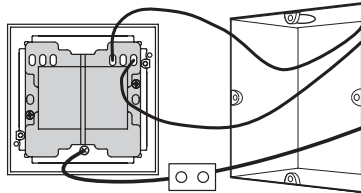

Reference Wiring Diagram

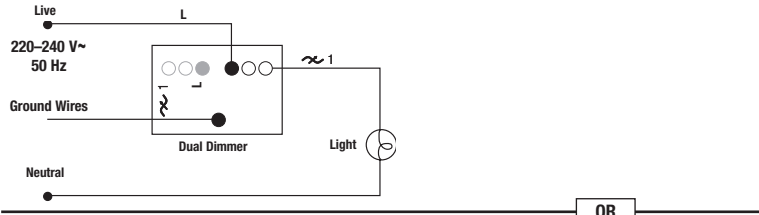

6b - Two-Location Wiring, Three Wire Control

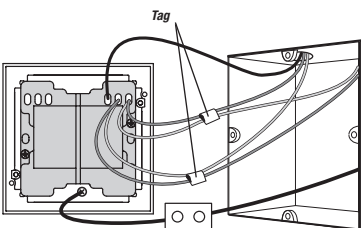

Reference Wiring Diagram

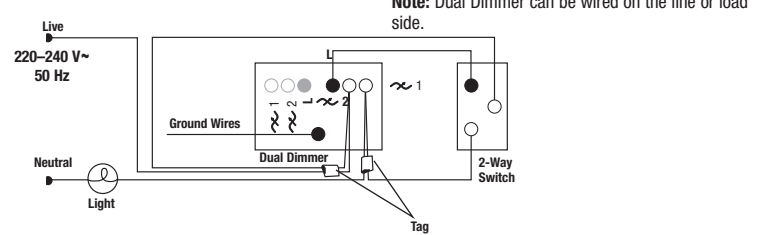

7 **Mount and align Dual Dimmer.**

Note: Ensure the "UP" arrow on the Dual Dimmer is facing UP when installing.

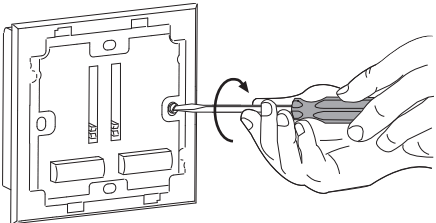

- Secure Dual Dimmer to the backbox.

Caution - Do not pinch wires. Do not overtighten mounting screws.

8 **Snap on Front Plate.**

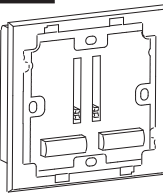

Important Alignment Step

- On the Dual Dimmer, move the sliders to the lowest travel position.
- On the Front Plate, move the knobs to the lowest travel position.

Note: This ensures proper alignment of the knobs and sliders.

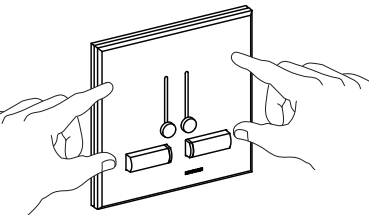

- Press corners to ensure four snaps engaged.
- Move the knobs up and down to confirm the knobs and sliders are properly aligned.

9 **Turn power ON at MCB (circuit breaker) or fuse box.**

Operation

Models: LLDI-252
LNDI-252

Dimming Knob

- Slide up to brighten.
- Slide down to dim.

Status Light

- Bright when lights are ON.
- Dim when lights are OFF.
- LLDI models only.

Model: LSDI-251

Dimming Knob

- Slide up to brighten.
- Slide down to dim.
- Click at bottom to turn OFF.

Problems

If your Dual Dimmer does not work, check that the light bulb has not burned out before contacting Lutron Technical Assistance.

Preset Dual Dimmer

Incandescent/Mains Voltage Halogen
LLDI-252, LNDI-252

Rated at: 220–240 V~ 50 Hz 40–250 W



Slide To Off Dual Dimmer

Incandescent/Mains Voltage Halogen
LSDI-251

Rated at: 220–240 V~ 50 Hz 40–250 W



Important Notes

Please read before installing.

- WARNING:** Do not use LLDI-252, LNDI-252 or LSDI-251 with magnetic (core and coil) low-voltage transformers or electronic (solid-state) low-voltage transformers.
- CAUTION:** To avoid overheating and possible damage to other equipment, do not use to control receptacles, fluorescent lighting fixtures, motor-operated or transformer-supplied appliances.
- Turn power OFF at MCB (circuit breaker) or fuse box before performing any routine maintenance or servicing of lighting circuit.
- For new installations, install a test switch before installing the Dual Dimmer to verify no short in the wiring.
- Protect Dual Dimmer from dust and dirt when painting or during construction.
- Only one Dual Dimmer can be used in a 2-way circuit.
- Dual Dimmer requires a minimum total lamp wattage of 40 W on each dimmer side. Do not exceed the maximum rating of 250 W per dimmer side.
- This Dual Dimmer complies with IEC and EN 60669-2-1.
- Minimum backbox depth is 35 mm.**
- Install in accordance with all national and local electrical codes.
- Operate between 0 °C and 40 °C. For indoor use only.
- Dual Dimmer may not work with dioded lamps.
- It is normal for the Dual Dimmer to feel warm to the touch during operation.
- Clean with a soft damp cloth only. DO NOT** use any chemical cleaners.
- Recommended torque for terminal block screws is 0.5 N•m.

Technical Assistance

If you have questions concerning the installation or operation of this product, call **Lutron's Headquarters**. Please provide exact model number when calling.

Lutron EA LTD

Tel: +44 (0) 207 702 0657
Fax: +44 (0) 207 480 6899
www.lutron.com/europe

FREEPHONE:

U.K.: 0800-282107
Spain: 900-974452
Northern China: 10-800-712-1536
Southern China: 10-800-120-1536
Hong Kong: 800-901-849
Singapore: 800-120-4491
Taiwan: 00-801-137-737
Thailand: 001-800-120-665853

Limited Warranty

Lutron EA Ltd. ("Lutron EA") warrants each unit to be free from defects in material and workmanship and to perform under normal use and service. To the extent permitted by law, Lutron EA and Lutron Electronics Co. Inc. ("Lutron") make no warranties or representations as to the units except as set forth herein. This warranty shall run for a period of two years from the date of purchase and Lutron's obligations under this warranty are limited to remedying any defect, replacing any defective part or replacement (at Lutron EA's sole option) and shall be effective only if the defective unit is shipped to Lutron EA postage prepaid within 24 months after purchase of the unit. Repair or replacement of the unit does not affect the expiry date of the warranty. This warranty does not cover damage or deficiencies due to abuse, misuse, inadequate wiring or insulation or use or installation other than in accordance with instructions accompanying the unit. To the extent permitted by law, neither Lutron EA nor Lutron shall be liable for any other loss or damage including consequential or special loss or damages, loss of profits, loss of income, or loss of contracts arising out of or relating to the supply of the unit or the use of the unit and the purchaser assumes and will hold harmless Lutron EA and Lutron in respect of all such loss or damage. Nothing in this warranty shall have the effect of limiting or excluding Lutron EA's or Lutron's liability for fraud or for death or personal injury resulting from its own negligence, or any other liability, if and to the extent that the same may not be limited or excluded as a matter of law. **This warranty does not affect the statutory rights of consumer purchasers of this product.** Although every attempt is made to ensure that catalogue information is accurate and up-to-date, please check with Lutron EA before specifying or purchasing this equipment to confirm availability, exact specifications, and suitability for your application. EC Registered Design Nos 000409610 and 000409628; and corresponding patents and design registrations of other countries. Patents pending. Lutron is a registered trademark in the United Kingdom and the Community Trademark System and Lyneo is a trademark of Lutron Electronics Co., Inc. © 2006 Lutron Electronics Co., Inc.

Installation

1 WARNING: Turn power OFF at MCB (circuit breaker) or fuse box.

2 Remove switch mounting screws. Remove switches from wall.

Note: DO NOT disconnect wires from the switches.

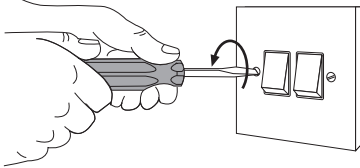
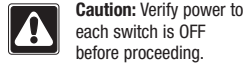

3 Tag the wire(s).

Note: Perform one of the following procedures on each switch.

Single-Location control

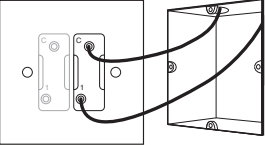

One switch controlling a light fixture.

No tagging is needed. This switch will be a 1-way. The switch will have insulated wires connected to two terminals.

See Step 6a when wiring.

Two-Location control

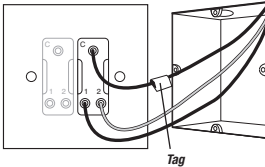

Two switches controlling a light fixture.

TAG the wire connected to the terminal labelled C or COMMON for identification during wiring. Both switches will be 2-way. Each switch will have insulated wires connected to three terminals. To replace a switch connected to five wires, see instructions on reverse.

See Step 6b when wiring.

Note: Terminal placement may be different on your existing switch.

Important Note:

Your wall switch may have two wires attached to the same terminal. Tape these two wires together before disconnecting. Connect these two wires to the same terminal in Step 6.

4 Disconnect switch wires.

5 Prepare Dual Dimmer for installation.

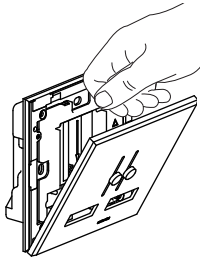

Snap off Front Plate

6 Wiring the control.

Important Wiring Information



WARNING: Permanent damage can be caused by overtightening the terminal screws. Recommended torque for terminal block screws is 0.5 N•m.

Trim or strip backbox wires to 8 mm. Insert wires fully into the terminals and tighten screws.

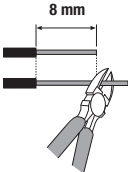

Notes: • Perform one of the following procedures on each side of the Dual Dimmer.

6a - Single-Location Wiring

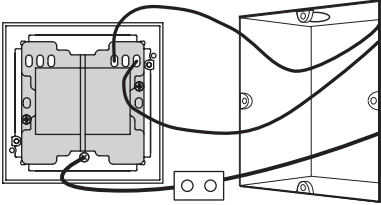

Reference Wiring Diagram

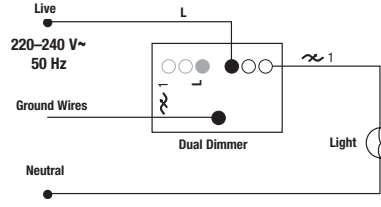

Models: LLDI-252, LNDI-252, LSDI-251

- Connect one of the insulated wires removed from the switch to terminal L.
- Connect the other insulated wire removed from the switch to the 1 terminal.
- Connect any earth wires to the green and yellow wire on the Dual Dimmer as shown. Alternatively, connect this green and yellow wire and the earth lug in the backbox.

Note: LSDI-251 only has 2 terminals.

6b - Two-Location Wiring, Two Wire Control

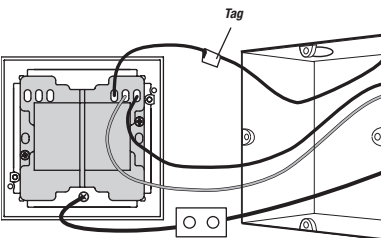

Reference Wiring Diagram

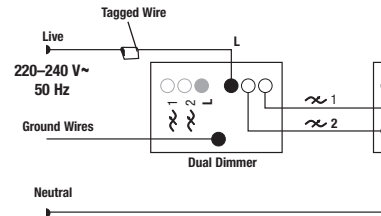

Models: LLDI-252, LNDI-252

Note: Only one dimmer can be used in a 2-way circuit.

- Connect the Tagged wire removed from the switch to terminal L.
- Connect one of the remaining wires removed from the switch to either 1 terminal.
- Connect the remaining wire removed from the switch to the remaining 2 terminal.
- Connect any earth wires to the green and yellow wire on the Dual Dimmer as shown. Alternatively, connect this green wire and the earth lug in the backbox.

Note: Dual Dimmer can be wired on the line or load side.

7 Mount and align Dual Dimmer.

Note: Ensure the "UP" arrow on the Dual Dimmer is facing UP when installing.

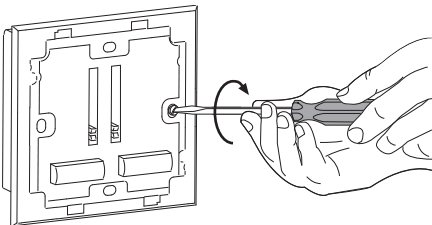

- Secure Dual Dimmer to the backbox.

Caution - Do not pinch wires. Do not overtighten mounting screws.

8 Snap on Front Plate.

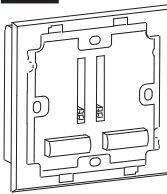

Important Alignment Step

- On the Dual Dimmer, move the sliders to the lowest travel position.
- On the Front Plate, move the knobs to the lowest travel position.

Note: This ensures proper alignment of the knobs and sliders.

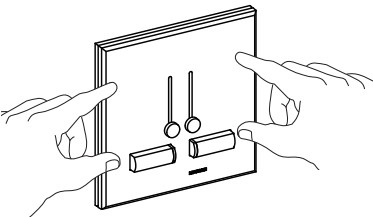

- Press corners to ensure four snaps engaged.
- Move the knobs up and down to confirm the knobs and sliders are properly aligned.

9 Turn power ON at MCB (circuit breaker) or fuse box.

Operation

Models: LLDI-252
LNDI-252

Dimming Knob

- Slide up to brighten.
- Slide down to dim.

Status Light

- Bright when lights are ON.
- Dim when lights are OFF.
- LLDI models only.

ON / OFF Button

Model: LSDI-251

Dimming Knob

- Slide up to brighten.
- Slide down to dim.
- Click at bottom to turn OFF.

Problems

If your Dual Dimmer does not work, check that the light bulb has not burned out before contacting Lutron Technical Assistance.